

# Auto Ignition Butane Gas Torch Instructions



## Operating Instructions:

Turn flame control knob clockwise to off position.

Looking down from the top of the torch, ensure the locking tab is rotated clockwise to the stop.

Align the torch with the top of the gas canister and press down gently.

Rotate the tab approx. 35 degrees anti-clockwise to lock the torch to the canister.

Turn flame control knob sufficiently anti-clockwise to start gas flow and press knob for ignition.

Adjust the knob to set the flame to the desired size.

Turn flame control knob clockwise to off position after use.

It is recommended the torch is removed from the gas canister when placing in storage to prevent possible gas leakage.

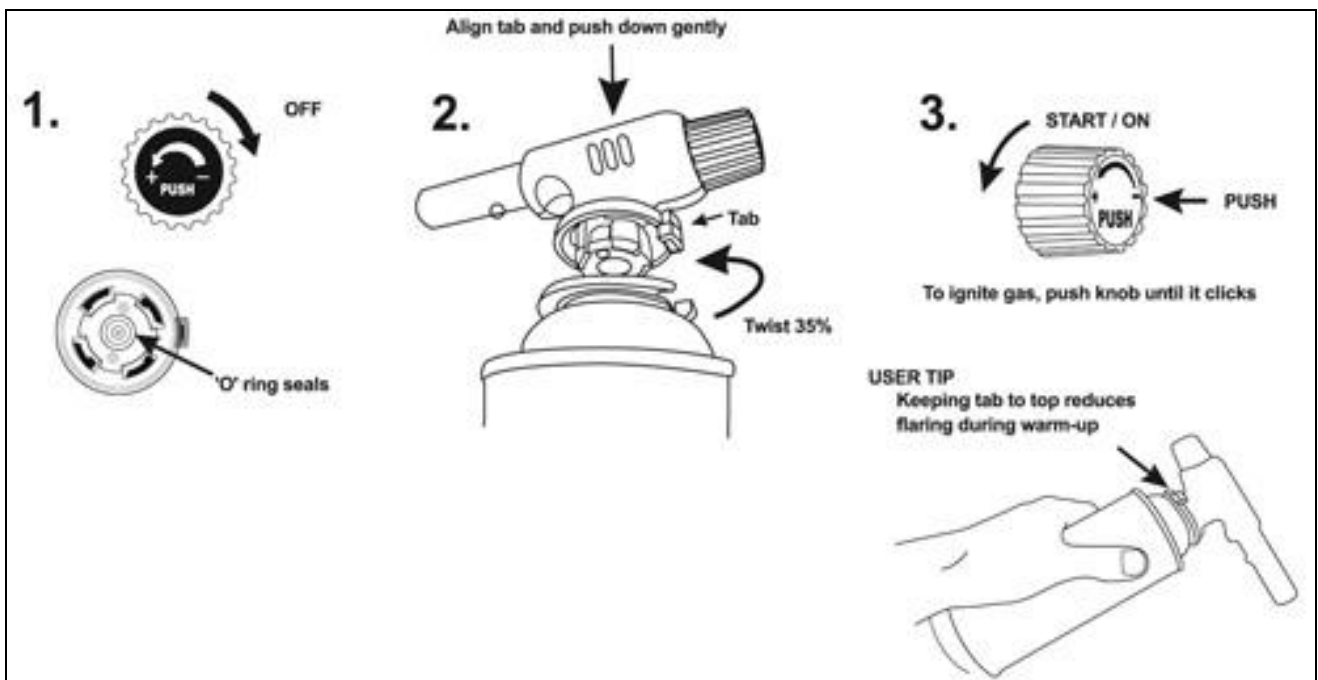

## Caution:

The metal tip will become hot during use.

Allow to cool prior to touching or placing the torch into storage.